



*Working Together for a  
Better Tomorrow, Today.*

DATE: April 12, 2023

NUMBER OF PAGES: 4

SENT DOCUMENT TO:

SENDER: Todd McCoy, Parks & Recreation Director  
Parks & Recreation Dept., City of Grand Island, Nebraska  
SENDER'S FAX: (308) 385-5488  
Secretary's E-MAIL: pbuettner@grand-island.com  
SUBJECT: Addendum No. 1 – Stolley Park Paving Improvements

**ADDENDUM INFORMATION:**

**See changes to the Performance Grade Binders, Stockpile Location and Asphalt Core Locations on the attached three (3) pages**

**Reminder: Bids are due April 18, 2023 at 2:00 pm local time.**

**INSTRUCTIONS:**

Please sign this page as acknowledgement of addendum receipt and return ASAP to the Parks & Recreation Department via fax, e-mail or mail.

Attn: Todd McCoy  
Parks & Recreation Director  
P. O. Box 1968  
Grand Island, NE 68802-1968  
(308) 389-0290  
Fax (308) 385-5488  
Email - pbuettner@grand-island.com

**ACKNOWLEDGEMENT OF RECEIPT OF ADDENDUM #1:**

Received by \_\_\_\_\_

Company \_\_\_\_\_ Date \_\_\_\_\_

**ADDENDUM NO. 1**  
**To**  
**2023 STOLLEY PARK PAVING PROJECT**  
**CITY OF GRAND ISLAND, NE**  
**Official Addendum Date: 04/12/2023**

**To Prospective Bidders:**

***A. Performance Grade Binders***

Grand Island Division IV – references NDOT Standard Specifications for Highway Construction 2017: Section 1029 - Performance Grade Binders. Added **PG64-22S** typically used for parking lots as an approved performance grade binder for this project.

***B. Stockpile Location***

The City of Grand Island Parks Department has determined a location for stockpiled materials and is shown on the Attachment A.

***C. Asphalt Core Locations***

The asphalt core locations done during the design are included as reference on Attachment B.

**END OF ADDITIONS/CLARIFICATIONS PER ADDENDUM NO. 1**

Prepared by:  
Alfred Benesch & Company  
1207 Allen Drive  
Grand Island, NE 68803  
Office (308) 384-1032

SURVEY CONTROL POINTS				
CP ID	NORTHING	EASTING	ELEVATION	DESCRIPTION
CP-1	94720.22	119382.70	1895.78	REBAR
CP-2	94712.59	119197.21	1895.58	REBAR
CP-3	94513.97	118981.57	1895.27	REBAR
CP-5	94315.76	118144.01	1895.79	REBAR
CP-7	94729.65	118465.14	1897.55	REBAR

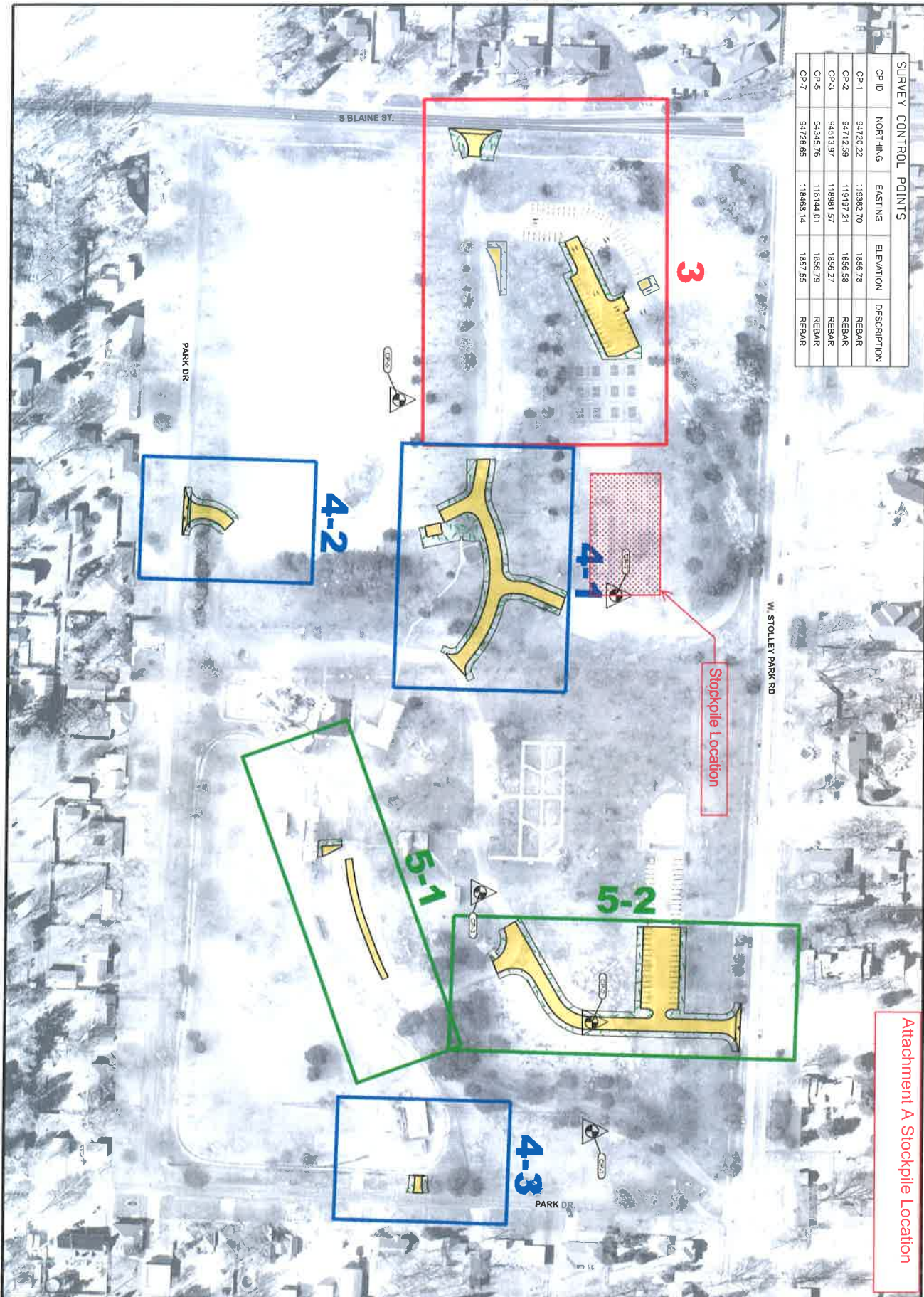

Attachment A Stockpile Location

SHEET INDEX AND CONTROL

CITY OF GRAND ISLAND PARKS AND RECREATION  
 STOLLEY PARK REHABILITATION  
 GRAND ISLAND, NEBRASKA

DATE	BY	REVISIONS	DESCRIPTION





Attachment B Stolley Park Core Map

200ft

200.00 ft