

MANHOLE NOTES:

1. INSIDE DIAMETER OF MANHOLES TO BE 4'-0" FOR PIPE THROUGH 24"; 5'-0" FOR PIPE 27" THROUGH 36"; 6'-0" FOR PIPE 42" THROUGH 48"; AND 7'-0" FOR 54" PIPE.
2. 12" MINIMUM THICKNESS ADJUSTING RINGS UNDER MANHOLE RING IS REQUIRED WHEN MANHOLE IS LOCATED IN ROADWAYS, PARKING AREAS, SIDEWALKS, ETC.
3. ANY MATERIAL EXCAVATED BENEATH PIPE ENTERING OR LEAVING MANHOLES SHALL BE REPLACED WITH CONCRETE; SUCH CONCRETE FILL SHALL EXTEND TO THE CENTER OF THE PIPE FOR A DISTANCE OF AT LEAST 3'-0" FROM THE FACE OF THE MANHOLE AND SHALL TERMINATE AT A BELL.
4. PRECAST MANHOLE CIRCULAR SECTIONS TO BE PER A.S.T.M. C-478.
5. MANHOLE INVERTS SHALL BE POURED CONCRETE. SEE STD. PLAN I30.5 FOR PLAN VIEW.
6. ALL CONCRETE TO CONFORM TO DIVISION V STORM & SANITARY SEWERS SULFATE RESISTANT CONCRETE SPECIFICATIONS.
7. IF SULFATE RESISTANT CONCRETE IS UNAVAILABLE, CONSHEILD CAN BE ADDED IN TYPE I MANHOLES AS A SUBSTITUTE.
8. ECCENTRIC OR CONCENTRIC CONE SECTIONS ACCEPTABLE TO USE.
9. WITHIN PAVED ROUTES, ADJUSTMENT RING SHALL BE CONSTRUCTED OF A SOLID MATERIAL. HONEYCOMB OR HOLLOW TYPE OF ADJUSTMENT RINGS ARE PROHIBITED.

MANHOLE RING & COVER TO BE DEETER NO. 1030 OR EQUAL, WITH MACHINED EDGES & MINIMUM WEIGHT OF 380 LBS. SEE STD. PLAN I30.5

USE HDPE, EPP, CONCRETE OR STEEL ADJUSTING RINGS TO ADJUST RING AND COVER TO GRADE

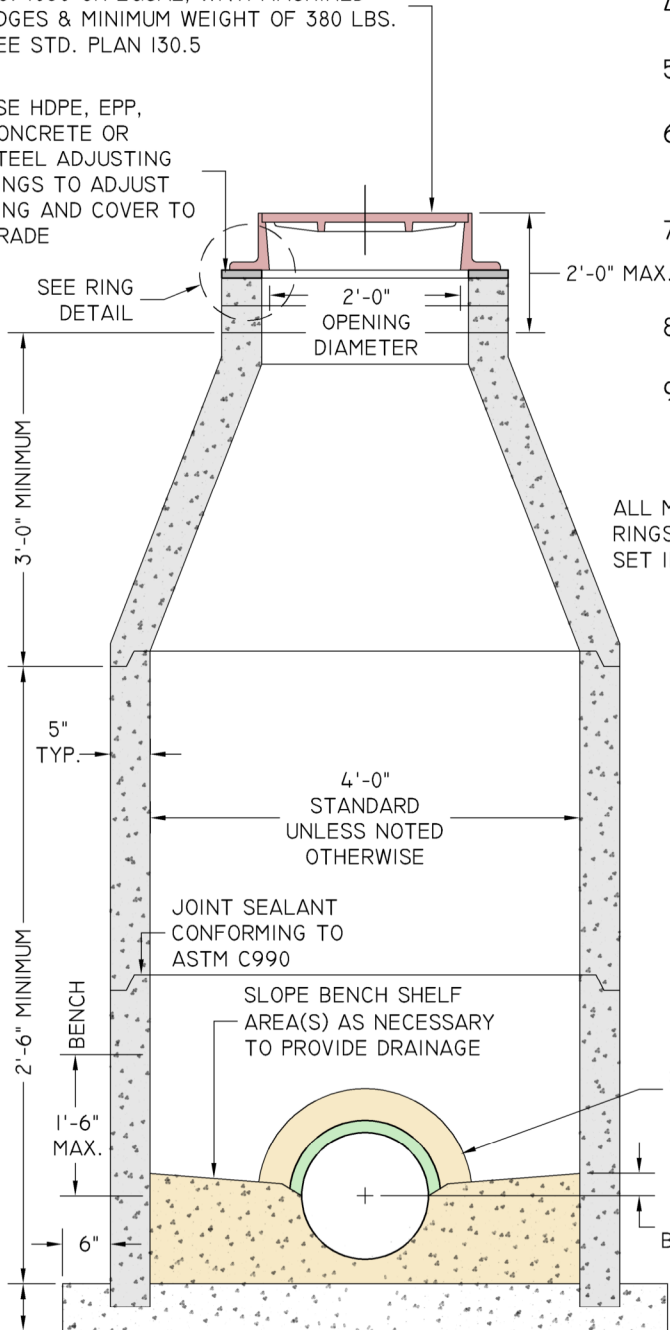

ALL MANHOLE RINGS TO BE SET IN MORTAR

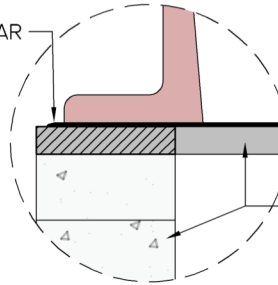

USE HDPE, EPP, CONCRETE OR STEEL ADJUSTING RINGS TO ADJUST RING AND COVER TO GRADE. FOLLOW MANUFACTURERS SETTING, AND SEALING INSTRUCTIONS.

RING DETAIL

SEE PLAN I30.3 FOR CONNECTION DETAIL

3" MINIMUM BENCH SLOPE

"T" "T" = 6" FOR 4' DIAMETER MANHOLE
"T" = 8" FOR 5' DIAMETER MANHOLE

NOT TO SCALE