

# ADDENDUM

	Overnight
	Regular Mail
	Hand Delivery
<b>X</b>	E-mail

<b>TO:</b>	City of Grand Island, Nebraska
<b>FROM:</b>	Andrew M. Phillips, P.E. Olsson Associates Caleb Strate, E.I. Olsson Associates
<b>RE:</b>	<b>Grand Island Sanitary Sewer Lift Station #7 Repairs Grand Island, Nebraska</b>
<b>DATE:</b>	November 15, 2011
<b>PROJECT #:</b>	011-2281
<b>PHASE/TASK #:</b>	100-100002

The soil test borings were mislabeled on the boring location map attached to the geotechnical memorandum for the Grand Island Sanitary Sewer Lift Station #7 Repairs dated November 1, 2011. The boring location map attached to this addendum should replace the boring location map attached to the original geotechnical memorandum.

\*\*\*\*\*

This addendum is solely intended to provide modification to the Boring Location Map attached to the geotechnical memorandum for the Grand Island Sanitary Sewer Lift Station #7 Repairs (Olsson Project No. 011-2281, dated November 1, 2011).

We appreciate the opportunity to provide our services for this project. Should you have any questions regarding the information provided, please do not hesitate to contact us at your convenience.

Respectfully submitted,  
***Olsson Associates***

Prepared by:

Reviewed by:

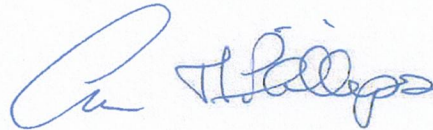

Caleb Strate, E.I.  
Assistant Engineer

Andrew M. Phillips, P.E.  
Geotechnical Engineer

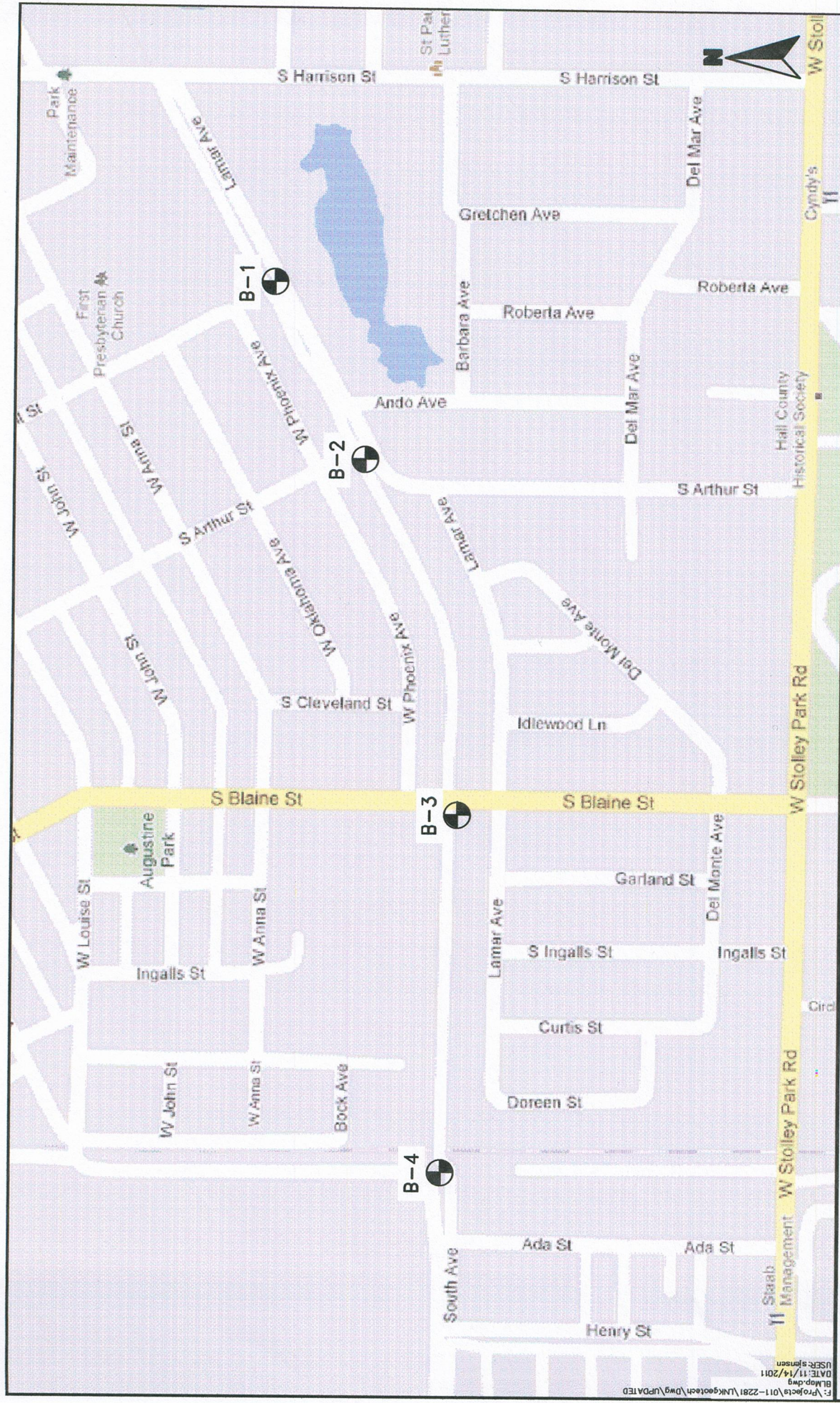

**OLSSON ASSOCIATES**  
 1111 Lincoln Mall, Suite 111 TEL 402.474.6311  
 P.O. Box 84608 FAX 402.474.5160  
 Lincoln, NE 68501-4608 www.oaconsulting.com

**LEGEND**

SOIL BORING LOCATION

PROJECT: 011-2281

DRAWN BY: SVJ REVISIONS: XXX

DATE: 11/14/11

SCALE IN FEET

0 500 1000

BORING LOCATION MAP  
 GRAND ISLAND, NEBRASKA

DATE: 11/14/2011  
 USER: sjensen  
 P:\Projects\011-2281\LINKS\tech\dwg\UPDATED